

4 Coding

S with standard scale 0...0,5, 10 graduations

Application example

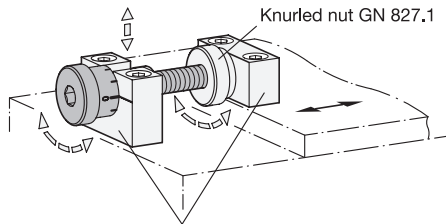
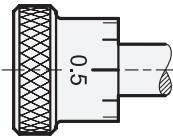

Bearing blocks GN 828

d₁	l₁			d₂^{-0,4 -0,6}	d₃	d₄	l₂ +0,1	l₃	l₄	s
M 6 x 1	20	35	50	6	10	16	10,1	14	2,9	5
M 8 x 1	30	45	60	8	14	20	12,1	16	3,9	6
M 10 x 1	40	60	80	10	16	24	15,1	18	5,9	8

Specification

- Stainless Steel AISI 303 **NG**
matte shot-blasted
- Scale
laser-engraved, black discharged
- Stainless Steel characteristics → Page 1483
- RoHS

Accessory

- Bearing blocks GN 828
- Stainless Steel-Knurled nuts GN 827.1
→ Page XYZ

Information

Stainless Steel-Adjusting screws GN 827 are used in combination with bearing blocks GN 828 for simple adjustment and positioning tasks. For processing and assembly equipment on which attachments and mechanisms must be regularly exchanged, particularly simple adjustments can be achieved by combining adjusting screws GN 827, knurled nuts GN 827.1 and bearing blocks GN 828 of the types UA and UB to ensure that settings are retained even between uses.

How to order

1	d₁
2	l₁
3	Material
4	Coding

GN 827-M8X1-45-NG-S

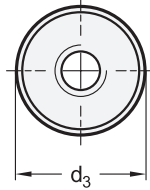
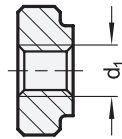
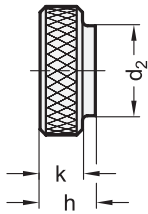

Application example

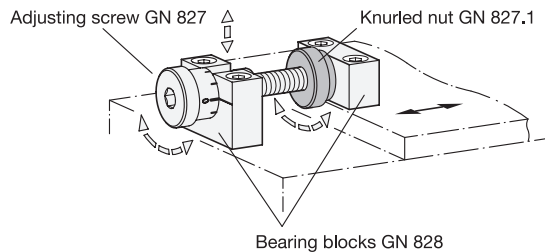

d_1	d_2	d_3	h	k
M 6 x 1	10	16	6	5
M 8 x 1	14	20	8	6
M 10 x 1	16	24	9	7

Specification

- Stainless Steel
AISI 304
matte shot-blasted

• *Stainless Steel characteristics* → Page 1489

- RoHS



NG

Information

Stainless Steel-Knurled nuts GN 827.1 are used with Stainless Steel-Adjusting screws GN 827 to secure settings and positions in place by counterlocking.

For processing and assembly equipment on which attachments and mechanisms must be regularly exchanged, particularly simple adjustments can be achieved by combining adjusting screws GN 827, knurled nuts GN 827.1 and bearing blocks GN 828 of the types UA and UB to ensure that settings are retained even between uses.

see also...

- *Stainless Steel-Adjusting screws GN 827* → Page QVX
- *Bearing blocks GN 828* → Page QVX

How to order

GN827.1-M8X1-NG

1 d_1

2 Material



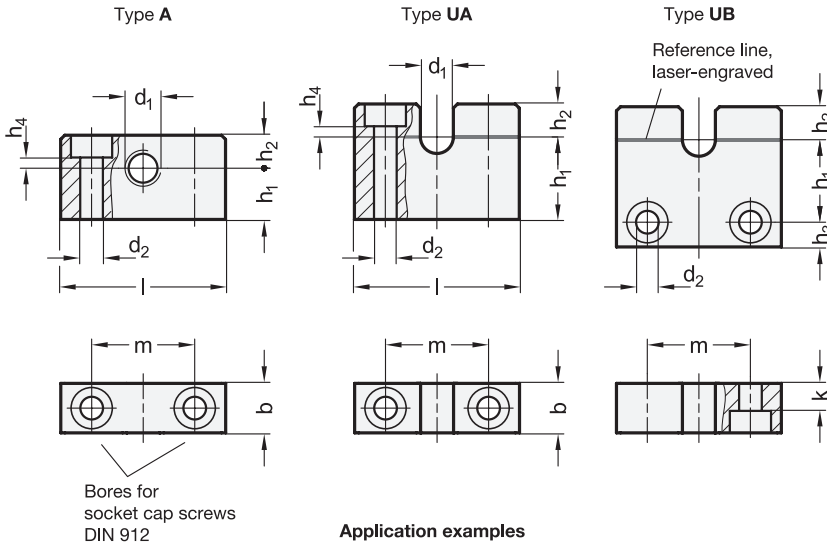

- 2 Type**
- A** With thread, mounting from above
 - UA** With groove, mounting from above
 - UB** With groove, mounting from the front

Application examples

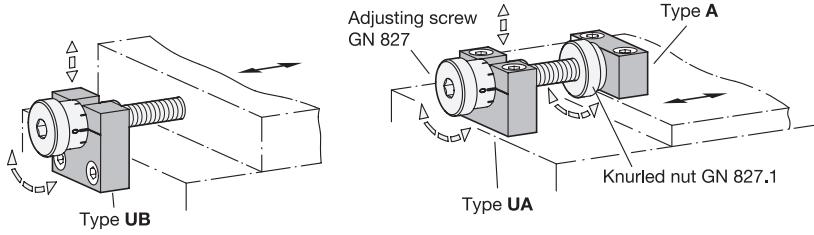

d ₁ Thread	d ₁ ^{+0.6} Bore +0.4	h ₁			b h11	d ₂	h ₂	h ₃	h ₄	k	Length l	m						
		Type A	Type UA	Type UB														
M 6 x 1	6	5	10	20	10	15	25	10	15	20	10	4,5	6	5	1,6	5,6	35	22
M 8 x 1	8	8	15	20	12	20	30	15	20	30	12	5,5	8	6	2,6	6,6	40	25
M 10 x 1	10	10	20	30	15	20	30	20	25	35	15	6,5	10	7,5	3,6	8,6	45	30

Specification

- Aluminum **AM**
Matte ground
- Reference line laser-engraved, black discharged
- ISO-Fundamental tolerances → Page 1479
- RoHS

Accessory

- Stainless Steel Adjusting Screws GN 827
- Stainless Steel Knurled Nuts GN 827.1
→ Page XYZ

Information

Bearing blocks GN 828 are used in combination with Stainless Steel Adjusting screws GN 827 for simple adjustment and positioning tasks.

For processing and assembly equipment on which attachments and mechanisms must be regularly exchanged, particularly simple adjustments can be achieved by combining adjusting screws GN 827, knurled nuts GN 827.1 and bearing blocks GN 828 of the types UA and UB to ensure that settings are retained even between uses.

On the opposing part, type A or threading already present in the mounting plate can be used.

How to order		1	d ₁
		2	Type
		3	h ₁
		4	Material